

SITE PLAN  
1:100

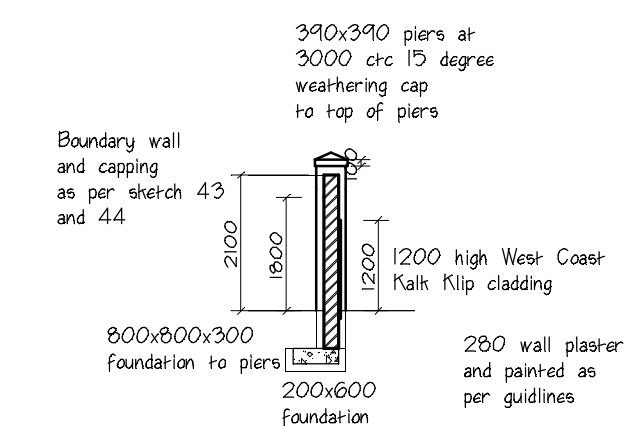

WALL SECTION  
SECTION MM  
1:100

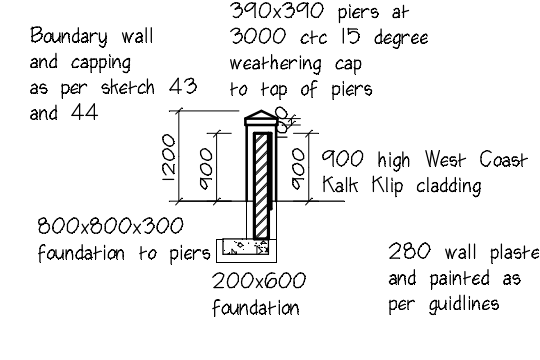
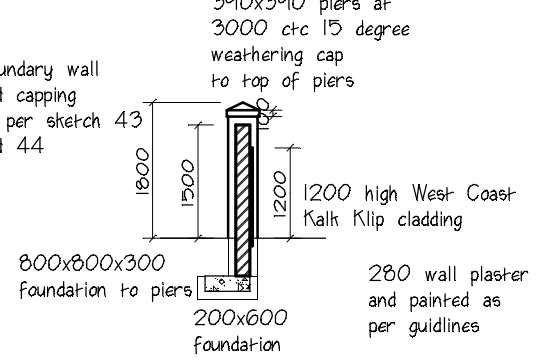
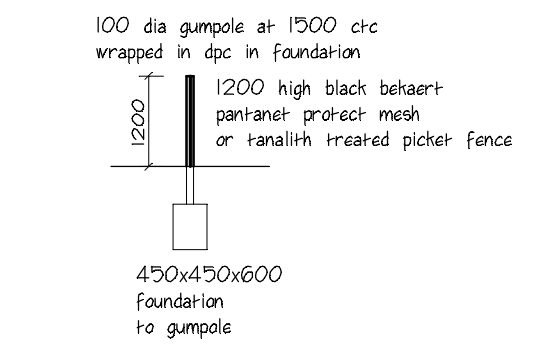
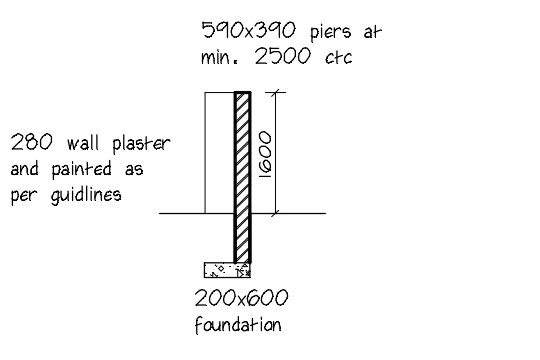
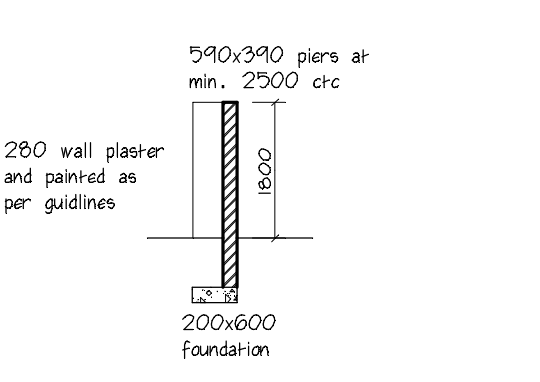
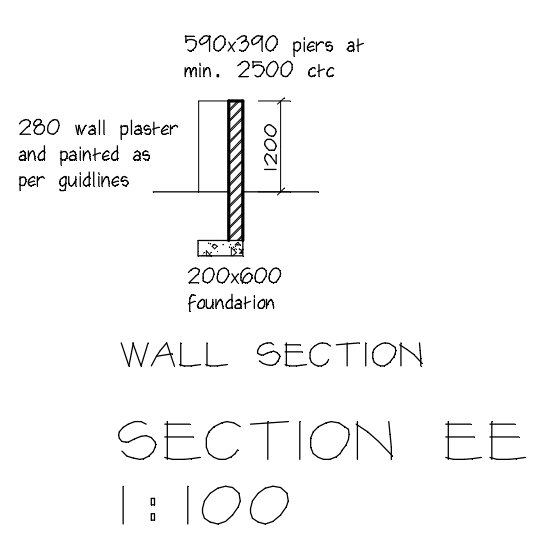
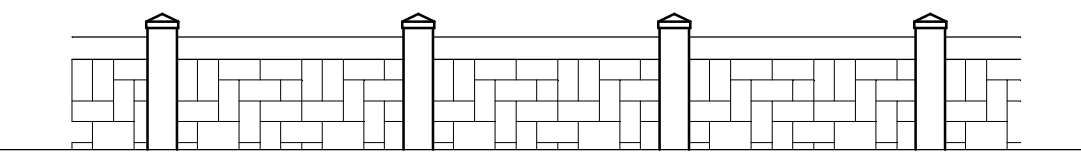

TYPICAL STREET BOUNDARY WALL ELEVATION  
1:100

- NOTES**
- SATELLITE DISHES**
    - \* Satellite dishes and TV aerials are to be fitted below main building from eave line. Satellite dishes may not be more than 600mm in diameter.
  - SERVICE PIPES**
    - \* Sewer and vent pipes to be concealed in vertical ducting but must be accessible for future maintenance.
  - AIR CONDITIONING**
    - \* Air conditioning condenser units to be installed, and screened at a maximum height of 1,2m taken from finished ground floor level. No window mounted units are permitted.
  - HOUSE NUMBERS AND NAMES**
    - \* House numbers may not higher than 100mm and wider than 75mm.
    - \* House may have names with the letters size not higher than 60 and the backing panel not bigger than 700 x 500
  - CLOTHES LINES/REFUSE BINS**
    - \* Clothes lines and refuse bins must be concealed within a service court with 1,8m boundary walling as per the guideline. Clotheslines are not to project above the service court wall.
  - LIGHTING EXTERNALLY**
    - \* External lighting to be preferably low level and down lighter type to match the general architectural guideline as per guideline item 1. No coloured light bulbs are permitted. Fluorescent and/ or ultra-violet lighting used for insect control should be located in areas with limited external visibility.
  - STORM WATER DISCHARGE**
    - \* No concentrated storm water is to discharge onto any neighbouring properties.
  - COMMUNAL REFUSE AREAS**
    - \* These refuse buildings should conform to the health and safety regulations of the local authority rule of Humb. 0.25sqm x amount of units. Roofed structure with internal water trap and point-screeded floor and adequate doors for storing and extraction of refuse.
  - PERGOLA**
    - \* Paving to match corobrick wheat paver with grey cobble stone border.
    - \* no shade cloths allowed
  - LANDSCAPE:**
    - \* Landscaping as per plant list available from LARC.
    - \* EXTERIOR LIGHT POINT, \*Regent Bevedrene (or equal) max 2400 high
- \* All relevant details, levels, dimensions to be checked before commencement of work.  
 \* Figured dimensions to be taken in preference to scaling drawings.  
 \* All work carried out strictly in accordance with municipality regulations.  
 \* This drawing is to be read in conjunction with sections, details and full project specifications.

**SITE DEVELOPMENT ON  
ERF 8397, LAGUNA SANDS  
LANGEBAAN**

**SITEPLAN  
OWNER SIGN:**

**DATE:  
FEBRUARY 2007**

**DRAWN BY:  
A. L. V.**

**SCALE:  
1:100**

**DRAWING NO.  
06/8397/01 - F**

box 11012  
blouberggrant  
tel/fax: 021 557 5604  
cell : 083 7095008

**anton van zyl**  
architectural  
design